

DIN 6325 Dowel pins

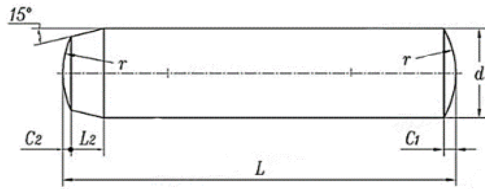

d	Φ0.8	Φ1	Φ1.5	Φ2	Φ2.5	Φ3	Φ4	Φ5	Φ6	Φ8	Φ10	Φ12	Φ14	Φ16	Φ20	
d	Max	0,808	1.008	1.508	2.008	2.508	3.008	4.012	5.012	6.012	8.015	10.015	12.018	14.018	16.018	20.021
	Min	0,802	1.002	1.502	2.002	2.502	3.002	4.004	5.004	6.004	8.006	10.006	12.007	14.007	16.007	20.008
L2	0.4	0.4	0.5	0.6	0.7	0.8	1	1.3	1.5	1.8	2	2.5	2.5	3	4	
r	0.8	1	1.6	2	2.5	3	4	5	6	8	10	12	16	16	20	
C1	0.12	0.15	0.23	0.3	0.4	0.45	0.6	0.75	0.9	1.2	1.5	1.8	2	2.5	3	
C2	0.06	0.08	0.12	0.18	0.25	0.3	0.4	0.5	0.6	0.8	1	1.3	1.3	1.7	2	
Length L																
5	X	X														
6	X	X	X	X	X	X	X									
8	X	X	X	X	X	X	X	X								
10	X	X	X	X	X	X	X	X	X	X						
12		X	X	X	X	X	X	X	X	X						
14			X	X	X	X	X	X	X	X	X					
16			X	X	X	X	X	X	X	X	X	X				
18			X	X	X	X	X	X	X	X	X	X				
20			X	X	X	X	X	X	X	X	X	X	X			
22			X	X	X	X	X	X	X	X	X	X	X			
24			X	X	X	X	X	X	X	X	X	X	X	X		
26			X	X	X	X	X	X	X	X	X	X	X	X		
28			X	X	X	X	X	X	X	X	X	X	X	X		
30			X	X	X	X	X	X	X	X	X	X	X	X		
32				X	X	X	X	X	X	X	X	X	X	X		
36				X	X	X	X	X	X	X	X	X	X	X		
40				X	X	X	X	X	X	X	X	X	X	X	X	
45				X	X	X	X	X	X	X	X	X	X	X	X	
50				X	X	X	X	X	X	X	X	X	X	X	X	
55						X	X	X	X	X	X	X	X	X	X	
60						X	X	X	X	X	X	X	X	X	X	
70							X	X	X	X	X	X	X	X	X	
80									X	X	X	X	X	X	X	
90									X	X	X	X	X	X	X	
100									X	X	X	X	X	X	X	
120											X	X	X	X	X	

Material: Steel with tensile strength not less than 600MPa
 Hardness: HRC60±2
 How to order : DIN 6325 -d-L . Order example: DIN 6325 -3-10.